

General

Productgroup	LF PowerBasket
Mounting type	Massive Pressfit Techn
Material	High performance alloy
Surface	silver
Customs tariff number	85369095
Country of origin	
Weight per piecs ~	0.002000 kg

Technical data

Terminal / Type	Bush through hole / Diameter
Diameter	5.700 mm
Socket diameter	11.900 mm
Socket height	12.25 mm
Height total	15.75 mm
Height over pcb	12.25 mm
No. of Pins	8
Pin length	3.50 mm
Pin alignment	Circumference

Processing

Press-in speed for press-fit types	100 up to 250
PCB thickness for SMT types	min. 1.00 mm
PCB thickness for press-fit types	1,60 up to 3,20 mm
Notice	

Current carrying capacity

Part (20°C) ~ / (85°C) ~	160.000 A / 96.000 A
--------------------------	----------------------

Usage and storage

Temperature	-40°C up to +150°C
Storage	dry environment protected from weather conditions
Storage conditions	at +5°C up to +40°C, 75% RH, non-condensing

Co-applicable documents

Powerelement Guidelines	Link to Powerelement Guidelines
-------------------------	---------------------------------

Footprint recommendation

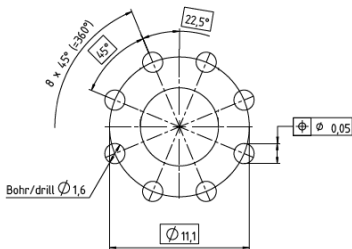

Drill hole specification for PCB or recommendation mask design

Drill Ø		drill tool	1,60 mm
		drill hole	1,60 mm - 0,025 mm
Cu		Cu – in Hole	Average 30 µm – 60 µm min. 25 µm, max. 80 µm *
End Ø		HAL	(1,450 mm +/- 0,05 mm)
		chem. surfaces	(1,475 mm +/- 0,05 mm)

Note: For Press-fit Technology drill diameter and copper thickness are fix. End Ø for reference only.

* single measurement points in microsection

Dimensions

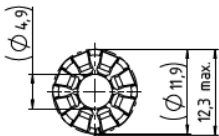
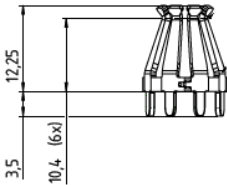

WÜRTH
ELEKTRONIK
MORE THAN
YOU EXPECT

Würth Elektronik ICS GmbH & Co. KG
Würthstraße 1 74676 Niedernhall, Germany
P +49 7940 9810-4444 lf-powerelement@we-online.de
www.lf-powerelements.com

Observe protective note ISO 16016. Passing on or duplication without previous written agreement forbidden. Violations oblige to compensation. All rights reserved in the event of a patent or utility model protection. Subject to change without notice! Is NOT subject to change service!

Generaltolerances
DIN ISO 2768-mH

Projection mode

Revision	Date	All measures in
B	10.07.25	mm

Part no.

K902364

Description

**LF PowerBasket Press-Fit Bush
vertical through hole**



RoHS
COMPLIANT
LEAD-FREE
Pb < 0,1 %