

General

Productgroup	PowerFlex
Mounting type	Flexible Pressfit Techn
Material	Bronze
Surface	tin-plated +
Customs tariff number	85369095
Country of origin	Federal Republic of Germany
Weight per piecs ~	0.002400 kg

Technical data

Terminal / Type	Bush through hole / Metric
Thread/Diameter x Length	4.000 mm x 4.00 mm
Torque	1.20 Nm

Socket length x Socket width	8.800 mm x 8.90 mm
Socket height	6.15 mm
Socket rounded	no
Height total	10.90 mm
Height over pcb	6.15 mm
No. of Pins	4
Pin length	4.75 mm
Grid dimension X / Y	5.08 mm / 7.62 mm
Pin alignment	Edge

Processing

Press in force	160 N up to 1000 N
Retention force	60-80 % of press-in force
Press-in speed	100 mm/min. up to 250 mm/min.
PCB thickness	1.60 mm up to 3.20 mm
Notice	

Current carrying capacity

Part (20 °C) ~ / (85 °C) ~	60.000 A / 35.000 A
----------------------------	---------------------

Usage and storage

Temperature	-40 °C up to +150 °C
Storage	dry environment protected from weather conditions
Storage conditions	at +5 °C up to +40 °C, 75% RH, non-condensing

Accessories

Press in tool	
---------------	--

Co-applicable documents

Powerelement Guidelines	Link to Powerelement Guidelines
-------------------------	---------------------------------

Standard drill pattern

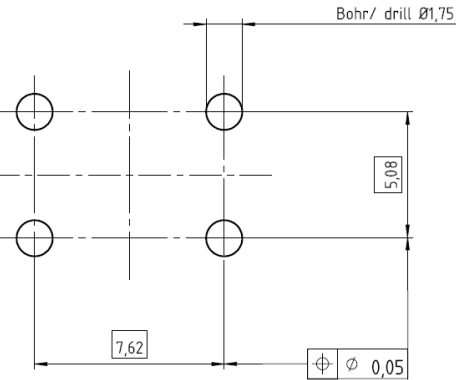

Drill hole specification for PCB

Drill Ø		drill tool	1,75 mm
		drill hole	1,75 mm +/- 0,025 mm
Cu		Cu – in Hole	Average 30 µm – 60 µm min. 25 µm, max. 80 µm *
End Ø		HAL chem. surfaces	(1,600 mm +/- 0,09 mm) (1,625 mm +/- 0,09 mm)
Note:	For Press-fit Technology drill diameter and copper thickness are fix. End Ø for reference only.		

* single measurement points in microsection

Dimensions

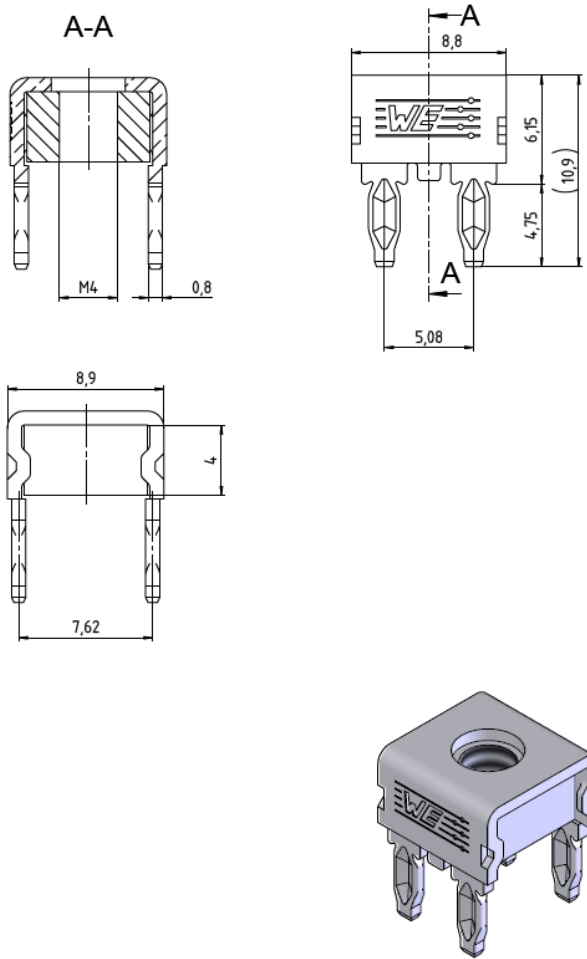

WÜRTH
ELEKTRONIK
MORE THAN
YOU EXPECT

Würth Elektronik ICS GmbH & Co. KG
Würthstraße 1 74676 Niedernhall, Germany
P +49 7940 9810-4444 powerelement@we-online.de
www.powerelement.com

Observe protective note ISO 16016. Passing on or duplication without previous written agreement forbidden. Violations oblige to compensation. All rights reserved in the event of a patent or utility model protection. Subject to change without notice! Is NOT subject to change service!

Generaltolerances
DIN ISO 2768-mH

Projection mode



Revision	Date	All measures in
D	23.06.25	mm

Part no.

S95243

Description

PowerFlex Bush vertical through hole



REACH
COMPLIANT



RoHS
COMPLIANT